

### Hanger Assembly (330A Hydro/400A Traction)

(42" Center Opening)

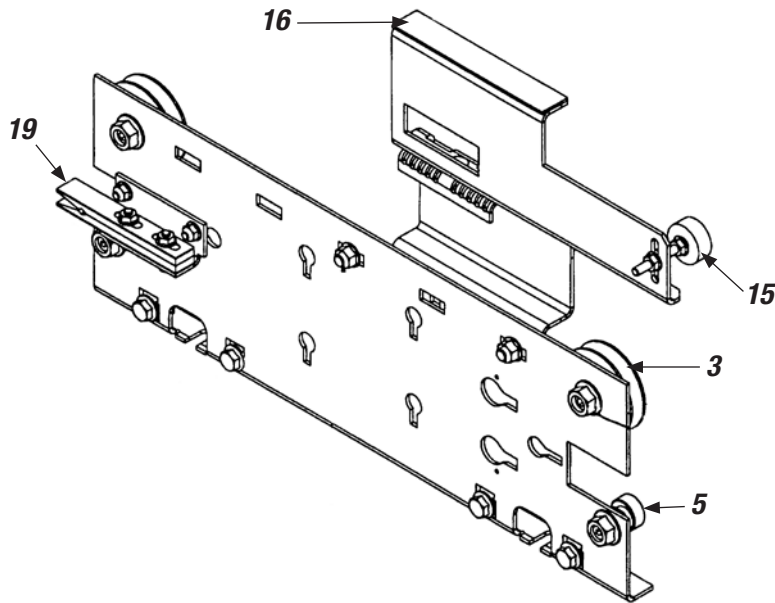

<b>HANGER ASSEMBLY</b>		
Key No.	Part No.	Description
3	<b>W415</b>	ROLLER
5	<b>W408P</b>	UP THRUST ROLLER ASSEMBLY
15	<b>5061A67G01</b>	GATE SWITCH ROLLER ASSEMBLY
15.1	<b>7431C95H15</b>	ROLLER
16 [1]	<b>1319B39H06</b>	MAGNETIC TAPE [2]
19A	<b>693B535H01</b>	LEAF SPRING
19B	<b>693B464H02</b>	DOOR HOLDING CAM