

Clutch and Restraint Assembly (330A Hydro/400A Traction)

R.H. CLUTCH ASSEMBLY SHOWN

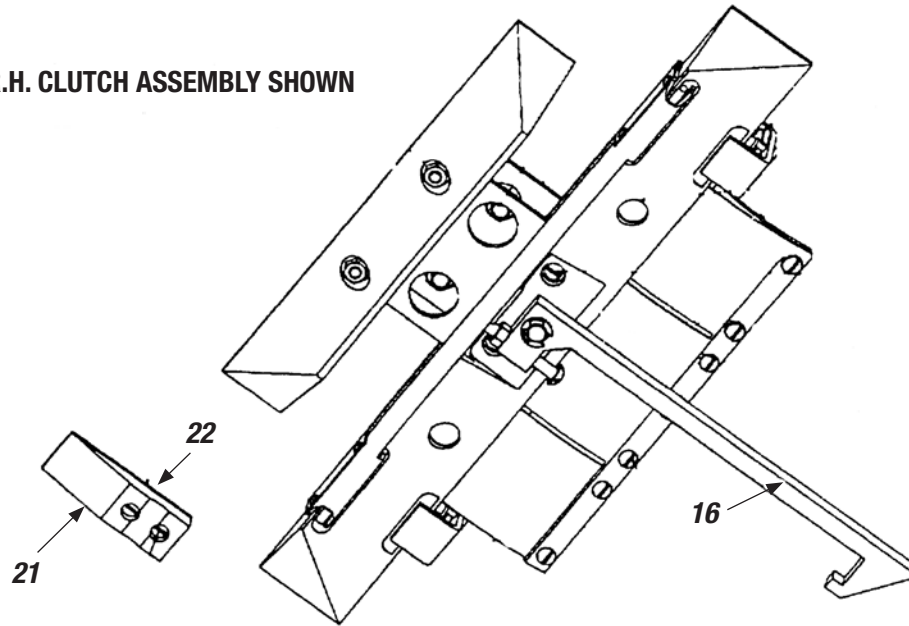

CLUTCH AND RESTRAINT ASSEMBLY		
Key No.	Part No.	Description
A	8535C72G01	RH CLUTCH ASSEMBLY
	8535C72G02 [4]	LH CLUTCH ASSEMBLY
16	8535C67G01	RH OPEN VANE ASSEMBLY
	8535C67G02	LH OPEN VANE ASSEMBLY
21	5065A51H01	RETRACTOR RAMP FOR QKS-16
22	5062A92H01	RAMP SHIM FOR QKS-16
23	8535C70H01	BOOT SPACER FOR QKS-16
24	5062A92H01	RAMP SPACER FOR QKS-16-VF

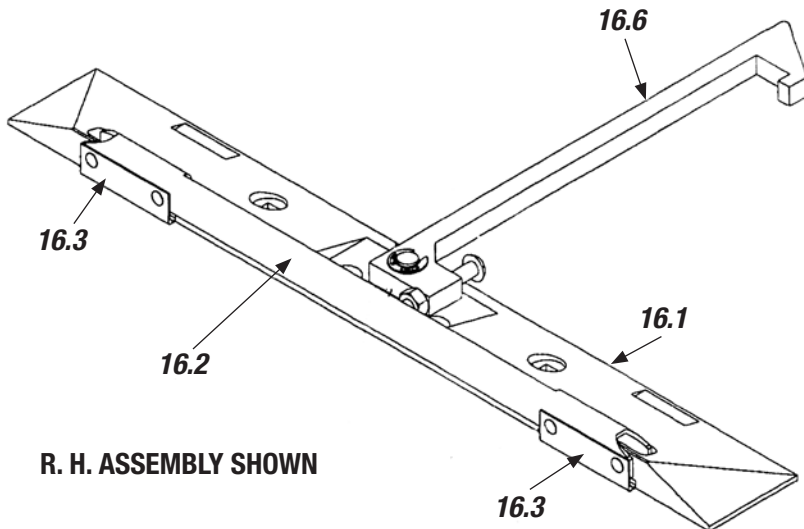

R. H. ASSEMBLY SHOWN

Key No.	Part No.	Description
16.1	8535C69H01	OPEN VANE
16.2	8535C66H01	ACTUATOR PLATE
16.3	5265A52H01	SPRING HINGE
16.6	6994C01G01	LINKAGE ARM ASSEMBLY