

# CabVision®

## END UNNECESSARY STOPS

### **CabVision® “Sees” When Your Elevator is Full and Switches to “Express Run” to Boost Efficiency**

CabVision® from Adams is a revolutionary new system designed to increase elevator efficiency and passenger satisfaction by identifying when your elevator is full and eliminating stops when there is no room for new passengers.

Large items such as luggage, shopping carts, and wheel chairs can fill an elevator without triggering weight capacity sensors. The CabVision system solves this problem by visually monitoring the floor space inside the cab, comparing a real-time picture of the elevator interior with a reference image stored in the unit. When a user-set threshold is reached, the unit sends the elevator controller a signal to perform an “express run,” bypassing hall calls until the cab has enough room for more passengers.

- Use stand-alone or in conjunction with existing load weight monitoring
- Intelligent vision sensor with infrared CMOS technology (complementary metal-oxide-semiconductor)
- Built-in image processing computer
- Automatic calibration and recalibration
- User-configured threshold setting
- No external controller or PC needed



# ADAMS

*More Parts Delivered Faster*

# CabVision®

## END UNNECESSARY STOPS



CabVision® can be mounted on wall or ceiling

### DIMENSIONAL INFORMATION

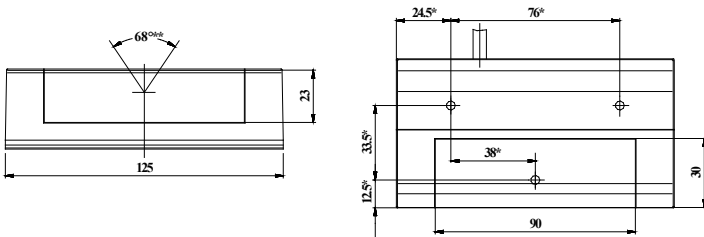

### MOUNTING

#### Ceiling Mounting

#### Wall Mounting

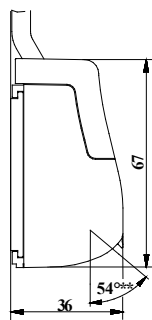
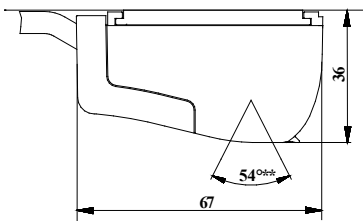

\* Mounting holes \*\* Optical aperture angle (All dimensions in mm)

### APPLICATION REQUIREMENTS

- The elevator control must support a bypass input
- Glass elevators should be avoided
- Adequate infrared light (e.g. from halogen bulbs) must be available
- Contact Adams for application assistance

### TECHNICAL DATA

OPTICAL		ELECTRICAL	
Detection Diameter	2.9 x 2.2 m @ 2.1m height	Supply voltage Us <sub>p</sub>	24 VDC ± 20%
Aperture angle	Horizontal 68°, vertical 54°	Current consumption	200 mA @ 24 VDC (w/o load)
Range Adjustment	Automatic	Relay output	30 VDC/1A
Recalibration time	Adjustable		42 VAC/1A
Max. ambient light	2,000 Lux	Response Time	50 ms, typical

MECHANICAL		GENERAL	
Dimensions (in mm)	125 x 67 x 37	Certificates	CE cCSAus pending for CSA B44.1 and ANSI/ASME A17.5
Enclosure rating	IP65		
Temperature range	-5° + 55°C		
Housing material	ABS, black		
Cable Length	2 m		
Cable type	11 wires, 26 AWG		

### CabVision ORDERING INFORMATION

ADAMS PART NO.	DESCRIPTION
<b>A851A</b>	CABVISION-V For vertical monitoring, mounting in center of elevator cab
<b>A851B</b>	CABVISION-A For angled monitoring, mounting in front, back or side of elevator cab
<b>A851C</b>	PWK-110VAC Wiring kit with pre-configured cables, power supply for 110 VAC
<b>A851D</b>	PWK-24VDC Wiring Kit with pre-configured cables, power supply for 24 VDC



ELEVATOR EQUIPMENT COMPANY  
www.adamselevator.com

6310 W. Howard Street • Niles, IL 60714-3480 USA

#### United States

Phone: 800-929-9247  
Fax: 847-581-2949  
adams.parts@adamselevator.com

#### Canada

Phone: 800-268-5392  
Toronto: 416-253-6661  
Fax: 416-253-1662

#### International

Phone: 847-965-0700  
Fax: 847-965-3758